

DESIGN GUIDELINES

Of Bedico Creek Preserve
Estates, Manors, Audubon Way
Heron Point, Audubon Oaks

March 2024

I. INTRODUCTION	1
Purpose	1
II. DESIGN GUIDELINES PROCESS.....	2
2.1 Commencement of Construction	2
2.2 Changes and Revisions	2
2.3 Architects and Designers.....	2
2.4 Design Review Submittal	3
2.5 The Design Review Process	3
2.6 Plan Submittal	4
2.7 Landscape Plan Submittal	5
2.8 Review Fees/Damage Deposits	6
2.9 Completion Schedule	6
2.10 Variance Requests.....	6
III. ARCHITECTURAL REQUIREMENTS	6
3.1 Architectural Elements	6
3.2 Committee Approval Timeline	7
3.3 Corner Lots	7
3.4 Ceiling Height	7
3.5 Setbacks.....	7
3.6 Drainage/Erosion.....	8
3.7 Driveways/Walkways	8
3.8 Fence Approvals	8
3.9 Address Numbers/Mailboxes.....	9

3.10 Tennis Courts.....	9
3.11 Pools, Spas, Hot Tubs	9
3.12 Satellite Dishes	9
3.13 Exterior/Security Lighting.....	9
3.14 Foundations.....	9
3.15 Fill Requirements.....	9
3.16 Slab Height.....	9
3.17 Exterior Materials/Colors	9
3.18 Window Coverings.....	10
3.19 Windows.....	10
3.20 Shutters	10
3.21 Gutters.....	10
3.22 Roof	10
3.23 Ridge Vents.....	10
3.24 Skylights/Solar Collectors	11
3.25 Chimneys/Stack Vents	11
3.26 Garages.....	11
3.27 Gazebos/Pigeonniers.....	11
3.28 Storage Sheds	11
3.29 Servitudes	11
3.30 Underground Utilities.....	11
IV. SPECIAL DESIGN GUIDELINES	11
4.1 Audubon Way Lots (239-242).....	12

4.2 Heron Point Lots (802-805)	12
4.3 Audubon Oaks Lots (1032-1038).....	13
V. LANDSCAPE REQUIREMENTS	13
5.2 Local Conditions	13
5.3 Landscape Design	13
5.4 Minimum Landscape Standards	14
Recommended Plant Materials.....	16
DESIGN REVIEW APPLICATION	21
INSTRUCTIONS FOR DESIGN REVIEW	22
EXHIBITS	23

**DESIGN GUIDELINES
OF
BEDICO CREEK PRESERVE**

Revised June 2023

I. INTRODUCTION.

Bedico Creek Preserve is designed to be a unique collection of neighborhoods in one master planned community in western St. Tammany Parish. The natural beauty, quality of open space and quantity of dedicated conservation acreage in an authentic Louisiana setting is an opportunity that escapes all others. The entrance features, parkway layout and neighborhood configurations are all designed so as to take full advantage of these natural amenities. The design of your new home and neighbors is reflected in the materials you select, the placement of landscaping as well as the preservation of existing plant material create a living wild life environment unmatched anywhere on the Northshore. These values along with respect for the natural systems around us drive our commitment to the conservation of this legacy.

1.1 Purpose -Bedico Creek Preserve Subdivision (the “Subdivision”) is a unique collection of neighborhoods in one master planned community each with its own unique character and designed homes. To ensure the community’s high standards, a plan review process has been established to review all individual building and landscape plans.

The authority to approve, disapprove or recommend modifications to building and landscape plans are provided by the recorded Declaration of Restrictions (the “Declaration”) for the Subdivision. The Declaration does not list specific design items necessary for plan approval but has created the Bedico Creek Owners Association with authority to review and approve or disapprove all individual building and landscape plans.

The Committee is composed of up to five (5) members. Additionally, a professional architect may serve as Chairperson of the Committee, to review and make recommendations with respect to all building plans. To explain the review process and what is required for plan approval, the Committee has developed these Design Guidelines. The Committee uses these Guidelines to review projects, but may consider individually the merits of any project due to special site conditions. Any project reviewed for special consideration must be shown to benefit the specific site adjacent areas or the Subdivision as a whole.

These Design Guidelines include without limitation, overall house image, scale, proportion and details along with appropriate and reasonable standards for all aspects of design, materials and finishes, such that, overall house image, scale, proportion, details, materials and finishes are desirable, appropriate and of the quality and character which the Committee deems

are compatible with the standards and character of the homes in the subdivision, and the Committee may exclude any such overall house images, scale, proportions, details, exterior finishes or materials which it deems undesirable or which, in its discretion, detracts from the value of the home or the surrounding homes or the general appearance or value of adjacent structures or the neighborhood. The Committee's vision and desires are intended to encourage design creativity that ensures individual yet compatible design character throughout the entire development. While each home design proposed will be reviewed based upon the criteria contained within these Design Guidelines, it is important to acknowledge that each submittal will also be reviewed based upon how well it relates to and supports the overall goal of creating a compatible street scape and fits within the overall neighborhood. It is through understanding and then implementing the desired appropriate character that the quality and value of the overall neighborhood along with the financial investment of each homeowner may be maximized. The Committee will seek to encourage the creation of aesthetically harmonious relationships among the homes within the Subdivision and between the particular lot and home. The Committee will encourage the development of a Subdivision of outstanding architectural statements, and the repetition of home designs will be limited. No Contemporary, Victorian or Spanish styles will be accepted. Only Classic, Time Tested, Regional, Traditional, Historic rural styles will be accepted.

Bedico Creek is made up of numerous neighborhoods, and as such, each neighborhood will have its own set of Design Guidelines.

II. DESIGN GUIDELINES PROCESS

2.1 Commencement of Construction - No residence, building, fence, wall or other improvement or structure shall be commenced, erected or maintained, nor shall any addition, change or alteration of any kind therein be made until properly, professionally prepared plans showing the nature, kind, shape, height, materials, floor plans, elevations, garage door and garage, the grading plan of the lot on which the improvements are to be erected, and such other matters as the Committee may require shall have been submitted to and approved in writing by a majority vote of the Committee and a copy thereof as finally approved lodged permanently with the Committee.

2.2 Changes and Revisions - All changes to final plans or materials must be submitted to the Committee and approved prior to implementation. If a homeowner/builder constructs a home or other structure which is other than that which is approved, including materials, the homeowner/ builder may be responsible for the removal or replacement of the non-conforming construction and/or materials at his own expense.

2.3 Architects and Designers - A pre-approved architect or home designer must be used for construction projects within Bedico Creek. The architects and designers composing the pre-approved list have demonstrated that they understand and are willing to comply with the vision and goals as called for in the Design Guidelines or who in the Committee's opinion have produced previous work which would meet the development's high standards.

You may obtain a copy of the list by contacting the Design Review Coordinator.

Contractors, architects and home designers who are interested in being considered for “approved” status should contact the Design Review Coordinator for a list of required criteria for submittal to be considered for preliminary approval.

Upon submitting qualifications and examples of previous work (documents and photographs of completed work), the request will be considered for preliminary approval.

Upon preliminary approval, the architect or designer will be required to attend a Design Review Orientation Meeting. Final Status will be determined following this meeting.

Approval may be reassessed given cause or annually.

The Committee reserves the right to remove any architect or designer from the approved list. Two examples of cause for removal are: preparation of incomplete design review submittals; repeated submission of designs for approval which do not comply with the appropriate character and detailed requirements as called for in the Design Guidelines.

NOTE: One's ability to draft and produce an industry standard set of home plans is not justification to be added to the approved list.

2.4 Design Review Submittal

The design review submittals are:

- A. Preliminary Design with Site Plan (optional)
- B. Final with Site Plan

Plans must consist of digital files as PDF.

All design reviews shall be based upon compliance with the Design Guidelines and the Restrictive Covenants (available at bedicocreekhoa.com / Password: bhomeowner). It is the Owner’s responsibility to comply with applicable building and zoning codes in effect. The design review process is in no way intended to be used as an analysis for determining errors or omissions in plans and specifications or design defects.

2.5 The Design Review Process – The design review process consists of the following:

1. Select your home designer from the list of Bedico Creek recommended designers.
2. Review the Design Guidelines with your designer.
3. Complete the Design Review Application for submittal with fee and deposits.
4. Submit Plans and Site Plan along with completed application, review fee, and deposits.

5. Revise plans, incorporating the Design Review Committee's comments, if any.
6. Final Plan Submission (digital files)
7. Revise Final plans, incorporating the Design Review Committee's comments, if any.
8. Receive Final Plan approved by the Design Review Committee.
9. Select a Builder (if not already selected)
10. Apply for STP building permit.
11. Begin Construction.
12. Complete home and install landscaping **prior to move in.**
13. Request Final Inspection in writing.
14. Correct any deficiencies.
15. Receive Approval of Design Review Coordinator.
16. Receive Refund of Damage Deposit.

2.6 Plan Submittal - Submittal shall consist of Digital Plans including:

1. Site Plan - Drawn to scale (1" 20'), including setbacks, servitudes, home and driveway placement, drainage swales and/or subsurface drainage (indicating flow of water) plus hardscape including: walls, fences, walkways, pools, spas, fountains, gazebos, pigeoneers, pergolas, or other detached structures. **Driveways must indicate the elevation to show that water will drain properly to appropriate catch basin. Include drainage flow on plot plan.**
2. Floor Plan - Drawn to scale (1/4" 1 foot.
3. All Building Elevations - All elevations must articulate materials, exterior finishes, windows, shutters, trim, fascia details and other architectural detailing. Dimensions, details and locations of all architectural elements (For example: Columns, Dormers, Shutters, Chimneys, etc.) must be provided.
4. Floor Plans

5. Roof Plan - must show all roof pitches and all plumbing penetrations or notation that no penetrations are located in the front of the home.
6. Completed Design Review Application
7. Submittal of Home Plan Design Review Fee
8. Submittal of Construction Damage Deposit

Approval or required revisions will be emailed to you.

Any changes to Plans after approval is given must be submitted and approved by the Committee prior to implementation. If a homeowner/builder constructs a home or structure other than that which is approved, he may be required to tear down or remove it at his own expense.

2.7 Landscape Plan Submittal – If requested by Committee, Landscape Plan Submittal shall consist of two full sets of landscape/hardscape plans (drawn to scale 1" = 10' minimum) including:

1. Scale of drawing 1" = 10'
2. Show existing footprint of home
3. Show all existing and proposed hardscapes, i.e. Walks, patios, fences, walls, pools and detached structures (pigeonniers and the like)
4. Show existing trees to remain
5. Show drainage swales along property lines and all subsurface drainage. (Indicate direction of flow)
6. Show variety, size, number and location of all plant material (This must be clearly labeled on Plan.)
7. Label areas to be sodded
8. Provide Plant Material List including:
 - a. Quantity
 - b. Botanical Name
 - c. Common Name
 - d. Size
9. Tree Removal plan
10. Provide bed preparation specifications
11. Provide screening details, i.e. Lattice, etc.

2.8 Review Fees /Damage Deposits - Damage Deposits and Review Fees must be submitted prior to or with submittal of preliminary plans. Fees and Deposits shall be made payable to: **Bedico Creek Preserve Property Owners Association, Inc.**

2.9 Completion Schedule - Once construction of a residence or any additional or outside structure has commenced it must be completed within twelve (12) months. Thereafter, at the discretion of the Committee up to \$100/day fine will accrue.

2.10 Variance Requests - Variance requests are considered and may be approved on a case-by-case basis. Prior to petitioning the committee for such a request, petitioner may be required to receive written approval in writing from adjacent property owners.

Review Fees and Deposits (See Design Review Application)

Refunds of Damage Deposit will be made in the following manner. Upon completion of the home, the owner shall request a final inspection of the home in writing. A representative of the Committee then makes an inspection of the home and landscaping. The owner is notified of any items which are in need of correction. Refund of both the deposits is conditioned upon repair of any and all items damaged, completion of all incomplete items, and adherence to all restrictions, within 90 days of home completion. This is evidenced by a satisfactory inspection of the property by an appointee of the Committee. Once the home has received a satisfactory final inspection, the deposits will be refunded within 15 days. Any damage caused by Owner, Owner’s contractor or subcontractors will be deducted from the deposit.

III ARCHITECTURAL REQUIREMENTS

3.1 Architectural Elements - Details, including the location, design, proportions and dimensions of Architectural elements, such as, dormers, columns, shutters, finials, stucco bands and quoins, etc., must be submitted to the Committee along with home plans and all specifications. These details and specifications are subject to the approval of the Committee.

A. Square Footage Requirements

<u>Neighborhood</u>	<u>Lots</u>	<u>Section</u>	<u>Min. Sq.Ft. Living Area</u>
Manors	117-122, 193-204	1-A	3,000
Estates	1-31, 205-214,	1-A	2,500
	215-228	17	2,500
Audubon Way	229-232	E-3	3,000
Heron Point	171-177, 796-807		
	123-124	B	3,000
Heron Point, Phase 2	138-150	C	2,200
	127-137	C	2,800
Audubon Oaks	125, 126, 151-170	C	3,000
	1032-1038	10-B	2,800

- 3.2. **Committee Approval Timeline** - In the event the Committee fails to approve or disapprove within twenty-one (21) days after any matter, including plans and specifications, has been submitted to it, approval shall not be required by the Committee; however, all other provisions of these restrictions shall continue to apply. This should not imply that plans or design elements which do not comply with architectural standards set forth herein will be considered approved.
- 3.3. **Corner Lots** - Both elevations facing streets edge must have aesthetically pleasing exteriors.
- 3.4. **Ceiling Height** - All residences shall be constructed with at least ninety (90%) percent of the ceilings on the ground floor not less than nine (9') feet high.
- 3.5. **Setbacks** - Unless approved in advance by the Committee and except as otherwise shown on the Final Plat of the Subdivision, front, rear, and side minimum building setback lines shall be as follows:

	Manors (Lots 117-122 & 193-204)	Estates (Lots 1-31, 205-214, & 222-228)	Audubon Way Homes (Lots 239-242)
Front	40'	35'	100'
Side	15' / Corner 15' min.	10' / Corner 15' min.	25'
Rear	35'	25'	75'

	Estates (Lots 221)	Estates (Lots 220, 218, 216)	Estates (Lots 219, 215, 217)
Front	40'	45'	50'
Side	10'/Corner 15'	10'/Corner 15' min	10'/Corner 15' min
Rear	25'	25'	25'

	Heron Point Lots 171-177, 796-801 123-124,806,807	Heron Point Lots 802-805	Heron Point Lots 138-150	Heron Point Lots 125-137, 151-170
Front	35'	100'	20'	35'
Side	10'/Corner 15' min.	25'	5'/Corner 10'	10'/Corner 20'
Rear	25'	75'	25'	25'

	Audubon Oaks Lots 1032-1038
Front	50'
Side	10'/Lot 1038 Right Side Yard Min. 25'
Rear	25'

If there is a conflict between the setbacks shown and the final plat, the greater distance should be used.

Any request for variance to setbacks must be made in writing to the Committee and must have Committee approval prior to implementation.

- 3.6 **Drainage/Erosion** - It shall be the owner/builder's responsibility to see that lots are graded to direct drainage to the street, except for lots which the final plat dictates otherwise. Drainage must be shown on the site plan for approval.

During construction, builders may use silt screen or bales of hay to control erosion and mud flow to streets, walkways and cart paths. During and after construction, erosion shall be controlled by completely sodding exposed slopes. The use of exposed drain pipe or impervious swale lining is prohibited; however, catch basins and buried drain pipe may be used. Each homesite shall have drainage swales along the rear and side property lines sloping toward the street. Lot owners are responsible for maintenance of these swales at all times.

- 3.7 **Driveways/Walkways** - All driveways must be laid out as per Exhibit A. Driveways shall be constructed no nearer than one (1') foot from the side property line or within 20' of an existing driveway. Driveways shall be constructed of concrete and shall have a width of not less than eleven (11') feet flaring to a maximum of eighteen (18') feet at street's edge. No driveway shall be permitted adjacent to another except where the configuration of lots dictate it necessary and then it must be approved by the Committee. The placement of driveways shall be in accordance with specifications as shown on Exhibit A. Walkways shall be constructed on each lot consisting of hard surfaced paths leading from the driveway to the front entrance of the home. Walkways shall be minimum of 42" in width. No walks to street are allowed except for corner lots.

The driveways finished grade must allow drainage from lot and adjacent lots to flow to appropriate catch basin.

- 3.8 **Fence Approvals** - All fence locations and details must be submitted to the Committee for approval prior to construction including details of decorative fences and non-perimeter fences. Existing fence designs located on adjacent lots must be resubmitted to the Committee for approval prior to construction. Gates are considered as part of fences and gate details must be submitted for approval. Chain link or wire fences are prohibited. Brick columns are allowed.

- A. **Fences** - Privacy fences shall be constructed of natural cedar or cypress that may be left to weather naturally without any treatment. Fences may be treated with Benjamin Moore clear Arbor Coat which acts as a sealer/preservative due to its water proofing capabilities or Thompson's Water Seal. All board fences must be shadowbox style as shown on Exhibit C and six (6') feet high, boards cannot be dog-eared but must use only wood posts, shadowboxing style with four inch (4") spaces between boards alternating on both sides of the fence and must be built on the property line. Shadowboxing allows for a two-sided fence each having an equally finished appearance. Therefore, it is recommended that fence costs be shared by adjoining lot owners. Iron picket, simulated wrought iron fences or anodized or

painted aluminum perimeter fences are allowed only on the Greenspace. Iron pickets or wrought iron like (i.e., aluminum) fences must be black and must conform to specifications of spacing, rail heights and post sizes as shown on Exhibit B.

- 3.9 **Address Numbers/Mailboxes** - Address numbers shall be displayed on mailboxes. The Committee has pre-selected the type and style of mailbox and requires property owners to select this style for their residence. Mailboxes shall be placed near the sidewalk or driveway close to the center of the lot.
- 3.10 **Tennis Courts** - Tennis Courts shall be soft color reds and greens. Black vinyl coated chain link fence and posts will be required for court fencing. Lights, if installed, must be shielded and may not intrude upon adjoining properties. A minimum setback of twenty-five (25') feet from the rear property line and/or the lake's edge is required. Any tennis court design and location must be approved by the Committee.
- 3.11 **Pools, Spas, Hot Tubs** - The design and location of pools, spas, and hot tubs shall be subject to the approval of the Committee and shall be harmonious with the architecture and landscape design. Pool fences shall conform to city requirements and the requirements for fencing in these restrictions. The equipment, location and screening will receive close review. No above ground pools are allowed.
- 3.12 **Satellite Dishes** - Service is available in Bedico Creek. The Design Review Committee may allow 18" Satellite dishes under the following conditions. Dishes must be ground mounted or mounted on the house but not visible from the street. The signal must not interfere with the reception of television or radio signals upon any other properties. The Design Review Committee will have the authority to grant or deny any request on a case-by-case basis.
- 3.13 **Exterior/Security Lighting** - Exterior site lighting and security lighting shall be shielded and not infringe upon adjacent neighbors or any public way. Utility poles shall be prohibited.
- 3.14 **Foundations** - Foundations should be properly designed by a structural engineer, the builder, designer or architect of your home. The Developer does not warrant soil conditions. City Parish regulation should be reviewed carefully for slab elevation requirements. If over 8" of slab is showing, it must be camouflaged by brick ledge or by screening with continuous landscape materials.
- 3.15 **Fill Requirements** – No higher than 12" above grade near slab and 6" above grade for drives and walks.
- 3.16 **Slab Height** – If any slab is 3' above crown of street, it must have a dropped brick ledge and be submitted for approval. No more than 12" of fill adjacent to slab.
- 3.17 **Exterior Materials/Colors** - The exterior of the home and accessory buildings shall be constructed of stucco, brick or siding approved by the Committee. Fake stone and lava rock are expressly prohibited. All siding must be wood or Hardie cement, smooth single

board lap siding subject to the approval of the Committee. The Committee requires the use of subdued, historically correct colors. No bright or strong colors will be allowed. Colors will be examined not only in relation to one another on the subject home, but in relation to other homes within the line of sight. **When in doubt, submit colors in advance for approval. The Committee has the authority to disapprove color choices and force the re-painting of color choices that are not harmonious within the community.** Any changes in exterior colors or materials must be approved by the Committee, as must all changes to plans. Wood beams must be sealed with a clear sealant or naturally weathered.

- 3.18 **Window Coverings** - No foil, sheets, reflective materials, paper, or other inappropriate materials or bright colors shall be used on any windows for drapes, sunscreens, blinds, shades or other purpose on a temporary or permanent basis. For temporary window coverings, the committee suggests the use of inexpensive shades or blinds until permanent window coverings are installed. Interior window coverings shall be lined in a neutral color so as not to detract from the exterior of the home.
- 3.19 **Windows** - If clad windows are used, appropriate trim (as determined by the committee) must be used. Divided lights shall be vertical or horizontal and required on front elevations or windows viewed from the street unless deemed inappropriate by the Committee. If false dormers are used, appropriate window treatments must be used to prevent interior of attic from being seen or framing must be painted black so as not to be seen from street or obscure glass must be used.
- 3.20 **Shutters** - Shutter width should be proportionate to the window (1/2 the window width). Shutters on front elevations must have cast iron hinges and "S" hooks but do not need to be operable. All shutters must be approved by the Committee. Shutter details must be shown on elevation drawings. Picture windows should not have shutters. Closed shuttered windows shall not have battens showing, but the window shall be framed, and the attendant appropriate hardware shall be included. Where wood windows are required; false shutters must have hardware.
- 3.21 **Gutters** - Gutters may be made of aluminum painted to match fascia/soffits. Architectural profile gutters may be allowed if painted to match fascia/soffits.
- 3.22 **Roof** - The pitch of the main roof should be not less than an 8:12 pitch; minor, inconspicuous or appropriate areas may have a lower pitch. The Committee may approve a lesser pitch if designer can show that it is more appropriate to the proportions of the house. Recommended roof material colors are browns or grays. **English tiles along ridges are required.** False shadow line shingles will not be allowed.

The minimum roof composition requirement in Bedico Creek shall be **composition architecturally cut shingles**. Other roofing materials which may be used are laminated composition architecturally cut shingles, true slate, imitation slate or cedar shake shingles.

- 3.23 **Ridge Vents** - Only English Tiles along roof ridges will be allowed. Turban vents are allowed if used in an inconspicuous location.

- 3.24 **Skylights/Solar Collectors - Skylights Solar Collectors are not encouraged.** Skylights shall not be located on the front elevation or portion of the home. Only flat skylights/solar collectors shall be allowed. No bubble skylights will be permitted. Solar collectors may be placed in the rear of homes only. Skylights and solar collectors must be properly located and clearly shown on plans when submitted and must be approved prior to implementation. Details and dimensions must be included in submittal. All skylights must be approved by the committee.
- 3.25 **Chimneys/Stack Vents** - All exposed portions of chimneys must be brick, Hardie board, or stucco. Chimney caps are required and materials may be brick, slate, terra cotta, bronzed anodized aluminum or copper. All roof penetrations are to be located in the rear of the home where possible or the least visible section of roof mass.
- 3.26 **Garages** - All lots shall have enclosed garages. Garages should be designed to blend with the main home utilizing the same materials and details. Garages shall have a minimum inside clearance of 22'x22'. Garages should be of sufficient size to accommodate a minimum of two and not more than four automobile. All garages must be equipped with fully operational automatic garage door openers activated by remote control. Garage doors may be constructed of wood or painted metal. Garage doors must be raised panel. All garage doors must remain closed except for ingress and egress. Windows in garages that face the street must have appropriate window treatments (or obscure glass) to screen garage interior from the street. Lots within all Parcels may elect to have front courtyard, side-loading garages subject to the approval of the Committee. Building material above the garage door must be the same as the material on the rest of the garage. (E.g. Brick garages must have brick above the garage door, not siding or stucco.)
- 3.27 **Gazebos/Pigeonniers** - Gazebos, pigeonniers, pergolas and other detached structures should relate architecturally to the design of the home in both form and material. Details and location of all detached structures must be submitted for approval with the landscape plan and must be approved by the Committee.
- 3.28 **Storage Sheds** - Storage sheds must be attached to the home or garage and shall be constructed of the same materials as the residence. No pre-fab, free-standing structures shall be permitted.
- 3.29 **Servitudes** - Servitudes for installation, maintenance of utilities and drainage facilities are reserved as shown on the final plat of Bedico Creek Subdivision. Overhangs in servitudes will not be allowed without the written consent of the Committee and a copy of approval from the Parish.
- 3.30 **Underground Utilities** - This subdivision will be served by underground utilities only. Electric service from the electric distribution system to a residence must be underground.

IV. SPECIAL DESIGN GUIDELINES

It is the intent of these design guidelines to create a unique high-quality neighborhood

within the Bedico Creek Community. These guidelines will convey an understanding of the neighborhood vision and required architectural character and detailing for the Property.

These Special Design Guidelines are hereby established as an addition to the Bedico Creek Design Guidelines and Restrictions. Where these Special Design Guidelines are in conflict with the Bedico Creek Design Guidelines and Restrictions, the Special Design Guidelines shall govern.

4.1 Audubon Way Lots (239-242)

Landscape requirements.

- a) Each lot must have an entry feature (columns, gate, fencing, etc.) at the location that the drive meets the street. Privacy gates are optional.
- b) Drives can be asphalt or crushed stone or other approved by the committee
- c) Fencing across the front of the lots is required as follows: Split three rail fence (same as fencing at entry and pool); Columns – 2’x4’ brick columns (with cap) at each front property line. Brick to be used is Old Chicago.
- d) Side and rear yard is also allowed and could be a green hog wire fence, or other approved design.
- e) A tree clearing plan must be submitted for approval (trees and understory).
- f) No clearing in side yard or rear setbacks unless approved.
- g) All exterior lighting to have shields (no light shall encroach on neighboring properties).
- h) Must sod from tree line to street. Grass swales to be constructed and maintained by Lot Owner.
- i) Detached out buildings are restricted as follows:
Garages, barns, guest quarters, outdoor kitchens, and the like are allowed within the setbacks (as long as allowed by Parish)
- j) Because of the large lot size, it may be impractical to drain to the front. In addition to draining to the front, all lots will be allowed to drain across the rear of the Audubon lots to the drainage servitude to the north east of the lots. Any drainage across lots must be approved as to method and aesthetics by the ARC.

4.2 Heron Point Lots (802-805)

Landscape Requirements

- a) Each lot must have an entry feature (columns, gate, fencing, etc.) at the location that the drive meets the street. Privacy gates are optional.
- b) Drives can be asphalt or crushed stone or other approved by the committee
- c) A tree clearing plan must be submitted for approval (trees and understory).
- d) No clearing in side yard or rear setbacks unless approved.
- e) All exterior lighting to have shields (no light shall encroach on neighboring properties).
- f) Detached out buildings are restricted as follows:
Garages, barns, guest quarters, outdoor kitchens, and the like are allowed within the setbacks (as long as allowed by Parish)

Note: In addition to standard Bedico Creek dues, Heron Point owners will be billed

annually for additional expenses incurred as a result of the gate.

4.3 Audubon Oaks Lots (1032-1038)

Landscape Requirements

- a) 40' landscape servitude front of lots.
- b) Fencing-4' vinyl scalloped picket fence with federation caps-color: Avondale in front of lots. 6' vinyl privacy with federation caps-color: Avondale on side property lines.
- c) No fences or gates should be installed in the 40' front setback.
- d) Required sleeves in the driveway-each driveway must have 1 – 3" conduit in drive location specified by ARC.
- e) No tree will be removed from lot without prior approval from the Association (trees and understory).
- f) Homes must avoid (as much as feasible) the Live Oak trees.
- g) Driveways must be submitted and approved by the ARC, (must avoid Oak Trees).
- h) Concrete trash can pads need to be created at street line.
- i) Culvert and head walls are required and needs to include trash can pad.
- j) Small piers will be allowed into the lake with the design subject to ARC approval.

4.4 Audubon Oaks

Slab Elevation

- a) Floor elevations should be set at 18" above crown of street, which would be 23.5'.

V. LANDSCAPE REQUIREMENTS

5.2 Local Conditions

Attractive and well-maintained Landscaping is vitally important to the quality image of high-end neighborhoods and is especially important to the Bedico Creek Preserve. Specific focus is directed to soil conditions that can affect the success your landscape installation. Some of the project area was previously cleared, filled and is therefore without natural vegetation special care should be taken to apply soil amendments to add organic nutrients to the clay soils. All plant material installations needs a 50/50 ratio of native soils to a sandy organic planting mix. In addition, the site is relatively flat and drainage must be accomplished by final shaping of your lot to catch basins via grass swales. The use of native plant materials is encouraged for drought tolerance, pest and disease resistance. Irrigation systems are highly recommended for vigorous plant growth and persistent drought cycles. Local climatic conditions allow for trees, shrubs, ground covers and lawns to mature rapidly given proper selection and good care.

5.3 Landscape Design

Professional design is encouraged for all front yards. Widespread use of flowering trees, shrubs, perennials and annuals is desired. All areas of lots or sites not covered by

buildings, drives, patios, pools or walks must be planted. All plant materials should be well formed, healthy and disease free when planted, irrigated, fertilized, pruned and otherwise maintained throughout their life.

5.4 Minimum Landscape Standards

A. The specific requirements listed below are minimum standards only.

<u>Neighborhood</u>	<u>Min. Trees</u>	<u>Min. Shrubs</u>	<u>Min. Bed Area</u>
Estates	1/2000 sf	40	10% of front yard
Manors	1/2500 sf	50	10% of front yard
Audubon Way	Must save existing trees	60	5% of front yard
Heron Point (Lots 172-177, 796-801)	1/2500 sf	50	10% of front yard
Heron Point (Lots 802-805)	Must save existing trees	60	5% of front yard
Audubon Oaks (Lots 1032-1038)	1/2500 sf	60	10% of front yard

Note: Existing saved trees will count towards the above tree minimum

- B. Fifty percent (50%) of the trees shall be planted in the front yard with the remaining fifty percent (50%) planted elsewhere on the lot. Please note, **Corner Lots** are considered to have two front yards; therefore, two-thirds of the required plant materials (trees, shrubs and sod) are to be planted in these areas. The remaining one-third of the plant materials should be distributed over the remainder of the lot. Both street elevations of corner lots must be planted prior to move-in. There shall be no planting of shrubs or trees between the sidewalk and curb.
- C. Fifty percent (50%) of all required shrubs are to be planted in the front yard. 50% of the shrubs must be 5 gallon or larger and the balance must be 3 gallons. (See notation above regarding corner lots). This requirement may be altered by the Committee depending on size of material and overall appearance. Miniature/dwarf plants will not count toward minimum requirements.
- D. Complete sodding of the front yard, and both street yards of corner lots, from the front elevation of the home to the curb of the street must be completed prior to occupancy. Sodding, sprigging or seeding of all other areas of the homesite must be completed upon occupancy, but not more than thirty days after occupancy. Certified centipede is suggested; however, the Committee may approve Bermuda, St. Augustine or Zoysia. Except for corner lots, side and rear yards may be sprigged or seeded.
- E. All air-conditioning compressors, utility boxes, gas meters and pool equipment must be visually screened from the street, Greenspace, and side yard view by appropriate fencing, screening or landscaping. Evergreen plants shall be used for screening purposes and must be of a type that does not die back or meltdown in freezing temperatures. All air-conditioning units and pool equipment must be

screened from the street, side yard, and Greenspace or other amenity view prior to home occupancy.

- F. **The entire front elevation of the home (on corner lots both street elevations) must be landscaped and home construction must be completed prior to occupancy by the homeowner.** If owner moves in or occupies the home prior to home completion or the completion of landscaping, the owner shall forfeit the Deposit. Further, liquidated damages will be assessed on the property at the rate of \$100 per day until the landscaping and/or home construction is completed. Further, the owner will be responsible for paying liquidated damages to the Committee or the Committee shall have the right to lien the property for the balance of said damages plus costs of litigation, attorney's fees and collection of same.

Exceptions to this will be if within two (2) weeks of move in, there are more than four (4) certified rain days (per Weather Bureau), then owner will be allowed the number of days over four (4) certified rain days, beyond move in day to complete landscaping. (e.g. If there are seven (7) rain days, the owner will be allowed three (3) days beyond move in to complete landscaping). Any days in excess of allowable days will result in damages of \$100 per day.

Sodding, sprigging or seeding of all other areas of the homesite must be completed upon occupancy, but not more than thirty days after occupancy.

Additionally, on homes which are on the Greenspace or any Common Area (such as, the jogging/ nature trail), all remaining landscaping must be completed within 60 days of home completion or occupancy. Refunds of deposits on homes on the Greenspace and Common areas are made after all landscaping both front and rear yards is complete. Deposits will be held until all phases of the landscaping are completed.

Builders of speculative homes must have the front elevation of the home landscaped by substantial completion of the home.

For all homes, all remaining landscape planting must be completed within one (1) year of occupancy.

The Recommended Plant Materials List below contains suggested plant materials recommended for your lot. These materials were chosen for their compatibility with both the St. Tammany climate and the overall design theme. Other trees, shrubs and ground covers may be used with the approval of the Committee.

RECOMMENDED PLANT MATERIALS

TREES: LARGE

Common Name	Botanical Name	Uses, Qualities and Remarks
Live Oak*	<i>Quercus virginiana</i>	Evergreen, broad spreading shade tree
Willow Oak*	<i>Quercus phellos</i>	Shade tree, fine texture
Southern Red Oak	<i>Quercus falcata</i>	Shade tree, red fall color
Cherry Bark Oak*	<i>Quercus falcata 'pagodifolia'</i>	Red fall color, long lived shade tree
Cow Oak*	<i>Quercus michauxii</i>	Shade tree, fall color
Southern Magnolia*	<i>Magnolia grandiflora</i>	Evergreen, fragrant white flowers
Cypress	<i>Taxodium distichum</i>	Fall color, waterside planting,
Green Ash*	<i>Fraxinus pennsylvanica</i>	Fall color, excellent shade tree
Longleaf Pine*	<i>Pinus palustris</i>	Large evergreen
Slash Pine*	<i>Pinus Elliottii</i>	Evergreen
Tulip Tree	<i>Liriodendron tulipifera</i>	Good upright shade tree, fall color
Cottonwood*	<i>Populus deltoides</i>	Fastest growth shade tree
Lombardi Poplar	<i>Populus nigra Italica'</i>	Fast growth buffer tree, dry soils



TREES: MEDIUM

Common Name	Botanical Name	Uses, Qualities and Remarks
River Birch	<i>Betula nigra</i>	Interesting bark, yellow fall color, waterside planting
Swamp Red Maple*	<i>Acer rubrum 'Drummondii'</i>	Red flowers and fall color, waterside planting
Bradford Pear	<i>Pyrus Calleryana 'Bradford'</i>	Spring flowers, purple fall color

Chinese Elm	<i>Ulmus parvifolia</i>	Excellent patio tree, fine texture
American Holly	<i>Ilex opaca</i>	Evergreen, red berries, screen planting
Spruce Pine	<i>Pinus glabra</i>	Fine textured evergreen
Golden Rain Tree*	<i>Koelreuteria bipinnata</i>	Very fast growth, fall color, can freeze.
Weeping Willow	<i>Salix babylonica</i>	weeping form, waterside plant
Ginkgo*	<i>Ginkgo biloba</i>	Yellow fall color
Sweet Bay Magnolia	<i>Magnolia virginiana</i>	Flowering evergreen with striking silver color on underside of foliage
White Poplar	<i>Populus alba</i>	Fast growing salt tolerant shade tree

* Recommended for lots with no existing trees.



TREES: SMALL

Common Name	Botanical Name	Uses, Qualities and Remarks
Crape Myrtle	<i>Lagerstroemia indica</i>	Brilliant flower color, interesting bark, excellent patio or accent tree
Oriental Magnolia	<i>Magnolia Soulangeana</i>	Purple flowers, early bloomer, patio tree
Yaupon Holly	<i>Ilex vomitoria</i>	Evergreen, naturalistic plantings
Cherry Laurel	<i>Prunus caroliniana</i>	Evergreen, hedge and screen plantings, wildlife food

Sweet Olive	<i>Osmanthus fragrans</i>	Evergreen, fragrant flowers
Wax Myrtle	<i>Myrica cerifera</i>	Evergreen, screen and naturalistic plantings, wildlife food, waterside planting
Japanese Plum	<i>Eriobotrya japonica</i>	Wildlife food, coarse texture
Parasol Tree	<i>Firmiana simplex</i>	green trunks, coarse texture
Flowering Dogwood	<i>Cornus florida</i>	Flowering tree, fall color
White Fringe Tree	<i>Chionanthus virginicus</i>	Native flowering tree
Parsley Hawthorn	<i>Crataegus Marshallii</i>	Native flowering tree, fine texture detail design
Silver Bells	<i>Halesia diptera</i>	Native flowering tree, excellent for patio locations
Southern Crabapple	<i>Malus angustifolia</i>	Flowering tree, edible fruit



SHRUBS:

Common Name	Botanical Name	Uses, Qualities and Remarks
Hollies	<i>Ilex spp.</i>	Evergreen hedge, berries
Primrose Jasmine	<i>Jasminum Mesnyi</i>	Yellow flowers, spreading, pendulous form, screen
Nandina	<i>Nandina domestica</i>	Red berries and leaf color, accent plant
Red Tip Photinia	<i>Photinia glabra</i>	Large evergreen, red foliage color, screen and hedge plantings
Pittosporum	<i>Pittosporum tobira</i>	Large evergreen, fragrant flowers, screen
Indian Hawthorn	<i>Raphiolepis indica</i>	Low to medium evergreen shrub, pink or white flowers, very hardy

Dwarf Azalea	<i>Rhododendron obtusum</i>	Protected position, partial shade, brilliant flowers
Indian Azalea	<i>Rhododendron indica</i>	Large evergreen, partial shade, outstanding flowers, naturalistic planting
Camellia	<i>Camellia spp.</i>	Evergreen, flowering specimen
Gardenia	<i>Gardenia jasminoides</i> <i>Prostrata</i>	Dwarf shade tolerant evergreen, fragrant summer flowers
Wax Leaf Ligustrum	<i>Ligustrum japonicum</i>	Excellent evergreen hedge
Sago Palm	<i>Cycas revoluta</i>	Course texture, accent
Abelia	<i>Abelia grandiflora</i>	Summer flowering evergreen
Fatsia	<i>Fatsia japonica</i>	Course texture shade plant, detail design for protected areas
Leucothoe	<i>Leucothoe axillaris</i>	Shade tolerant lowland plant
Star Bush	<i>Illicium floridanum</i>	Large understory flowering evergreen
Banana Tree	<i>Michelia Figo</i>	Evergreen, screen, fragrant flowers



VINES:

Common Name	Botanical Name	Uses, Qualities and Remarks
Carolina Yellow Jessamine	<i>Gelsemium sempervirens</i>	Semi-evergreen, fragrant yellow flowers
Confederate Jasmine	<i>Trachelospermum jasminoides</i>	Evergreen, fragrant white flowers
Lady Banksia Rose	<i>Rosa banksiae</i>	Evergreen, climbing yellow flower
Wisteria	<i>Wisteria sinensis</i>	Fragrant blue-violet flowers, heavy, vigorous grower for garden structures
Fig Vine	<i>Ficus pumila</i>	Evergreen, popular wall covering
English Ivy	<i>Hedera Helix</i>	Shade tolerant evergreen, course texture
Fatsiedera	<i>Fatsiedera Lizei</i>	Shade tolerant evergreen, very course texture, detail design



GROUNDCOVERS:

Common Name	Botanical Name	Uses, Qualities and Remarks
Liriope	<i>Liriope Muscari</i>	Sun to shade, flower, border plant
Asian Jasmine	<i>Yachelospermum asiaticum</i>	Sun to part shade, forms dense mat
Monkey Grass	<i>Ophiopogon japonicus</i>	Part shade to shade, fine texture, grass-like
Horizontal Juniper	<i>Juniperus horizontalis</i>	Full sun, dry conditions, fall color
Aspidistra	<i>Aspidistra elatior</i>	Deep shade, coarse texture
Louisiana Iris	<i>Iris 'Louisiana'</i>	Water side and naturalistic plantings, full range of flower color, detail design
Wood or Marsh Fern	<i>Dryopteris spp.</i>	Shady positions, moist soils, naturalistic plantings
Ajuga	<i>Ajuga reptans</i>	Shade tolerance, detail design, low growing
Cattails	<i>Typha latifolia</i>	Waterside planting
Horsetail	<i>Equisetum hyemale</i>	Waterside planting



GRASS:

Common Name	Botanical Name	Uses, Qualities and Remarks
Centipede	<i>Eremochloa ophiuroides</i> 'Oaklawn'	Yellow green, medium coarse texture
Bermuda	<i>Cynodon Dactylon</i>	Dark blue-green, poor shade tolerance, fine texture
St. Augustine	<i>Stenotaphrum secundatum</i>	Dark blue-green, good shade tolerance, fine texture
Zoysia	<i>Zoysia spp.</i>	Dark green, extremely fine texture, good shade tolerance

**BEDICO CREEK PRESERVE
ESTATES, MANORS, AUDUBON WAY, HERON POINT, AUDUBON OAKS**

DESIGN REVIEW APPLICATION

DATE SUBMITTED _____ LOT # _____

OWNER'S NAME _____

OWNER'S ADDRESS _____

HOME PHONE _____ BUS PHONE _____ EMAIL _____

BUILDER _____ Phone/Email _____

ARCHITECT/DESIGNER _____ Phone/Email _____

CHECK ONE

To expedite approval process, please fill out form completely and accurately and submit with plans and required review fees and deposits (see instructions)

- | | | |
|--------------------------------------|--|--|
| <input type="checkbox"/> Custom | <input type="checkbox"/> Preliminary Home Design | <input type="checkbox"/> Plan Change |
| <input type="checkbox"/> Speculative | <input type="checkbox"/> Final Home Design | <input type="checkbox"/> Approved Plan Change |
| <input type="checkbox"/> Fence | <input type="checkbox"/> Pool | <input type="checkbox"/> Addition/Modification |

REVIEW FEES

Home Design Review Fee		Damage Deposit	
"Preferred" Builder	\$ 250	"Preferred" Builder	\$ 1,000
All other Builders	\$ 500	All other Builders	\$ 2,000
		Plan Change	\$ 100
Additional Review	\$ 100		
Pool Review	\$ 100		
Fence Review	\$ 50		

At the discretion of the ARC, and taking into consideration the builders past performance, a Select Builder, can be allowed one deposit for ALL jobs under construction.

Make checks payable to Bedico Creek Homeowner's Association

PLANS (ELECTRONIC) + SITE PLAN + REQUIRED FEES DEPOSITS ATTACHED

COMMITTEE ACTION

- APPROVED AS SUBMITTED APPROVED AS NOTED RESUBMIT OTHER

COMMENTS: _____

Approved By _____

Date _____

INSTRUCTIONS FOR DESIGN REVIEW

PLAN SUBMITTAL

Plan submittal must include the following:

- Completed Design Review Application
- 1 Electronic Set of Plans
- 1 Electronic copy of Site Plan
- Copy of check for the fees

Plans can be submitted through our password protected website:

Bedicohoa.com

Password: bhomeowner (all lower case)

Call 504-364-1370 for further details.

Email to: Kristi@cpmcnola.com

Questions: Kristi Pierson
504-364-1370 or email Kristi@cpmcnola.com

FEES:

MAIL TO: BEDICO CREEK PRESERVE PROPERTY OWNERS ASSN.
3520 HOLIDAY DRIVE, SUITE A,
NEW ORLEANS, LA 70114

Please include a copy of the review application with your payment.

EXHIBIT A

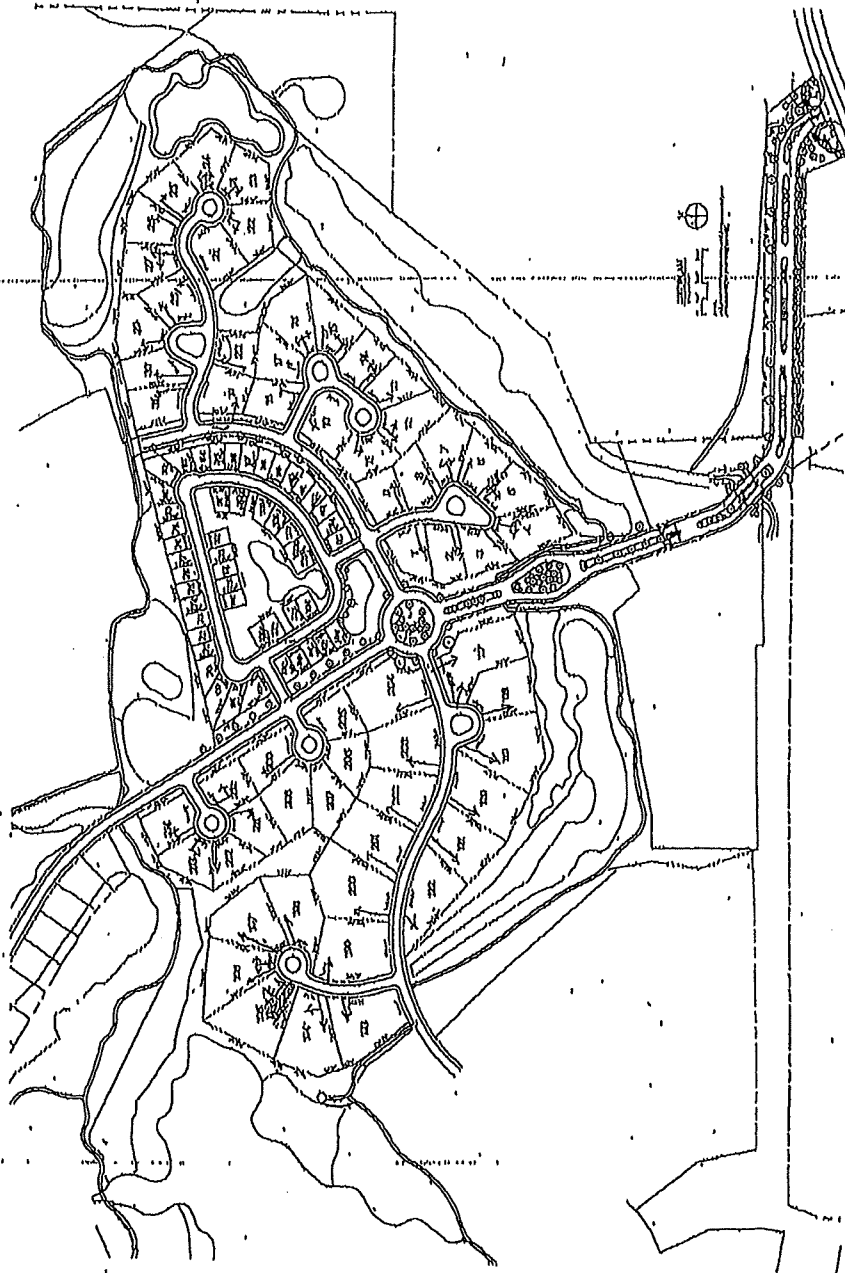

Exhibit A Green Point C-A Driveway layout



VICINITY MAP

DEDICO CREEK PARCEL C-1
SECTIONS 6 & 7 T-7-S, R-10-E,
GREENSHUO LAND DISTRICT
ST. TAMMANY PARISH, LA

RECORDS
RECORDS
RECORDS

1
2
3
4
5
6
7
8
9
10
11
12
13
14
15
16
17
18
19
20
21
22
23
24
25
26
27
28
29
30
31
32
33
34
35
36
37
38
39
40
41
42
43
44
45
46
47
48
49
50
51
52
53
54
55
56
57
58
59
60
61
62
63
64
65
66
67
68
69
70
71
72
73
74
75
76
77
78
79
80
81
82
83
84
85
86
87
88
89
90
91
92
93
94
95
96
97
98
99
100

101
102
103
104
105
106
107
108
109
110
111
112
113
114
115
116
117
118
119
120
121
122
123
124
125
126
127
128
129
130
131
132
133
134
135
136
137
138
139
140
141
142
143
144
145
146
147
148
149
150
151
152
153
154
155
156
157
158
159
160
161
162
163
164
165
166
167
168
169
170
171
172
173
174
175
176
177
178
179
180
181
182
183
184
185
186
187
188
189
190
191
192
193
194
195
196
197
198
199
200

201
202
203
204
205
206
207
208
209
210
211
212
213
214
215
216
217
218
219
220
221
222
223
224
225
226
227
228
229
230
231
232
233
234
235
236
237
238
239
240
241
242
243
244
245
246
247
248
249
250

251
252
253
254
255
256
257
258
259
260
261
262
263
264
265
266
267
268
269
270
271
272
273
274
275
276
277
278
279
280
281
282
283
284
285
286
287
288
289
290
291
292
293
294
295
296
297
298
299
300

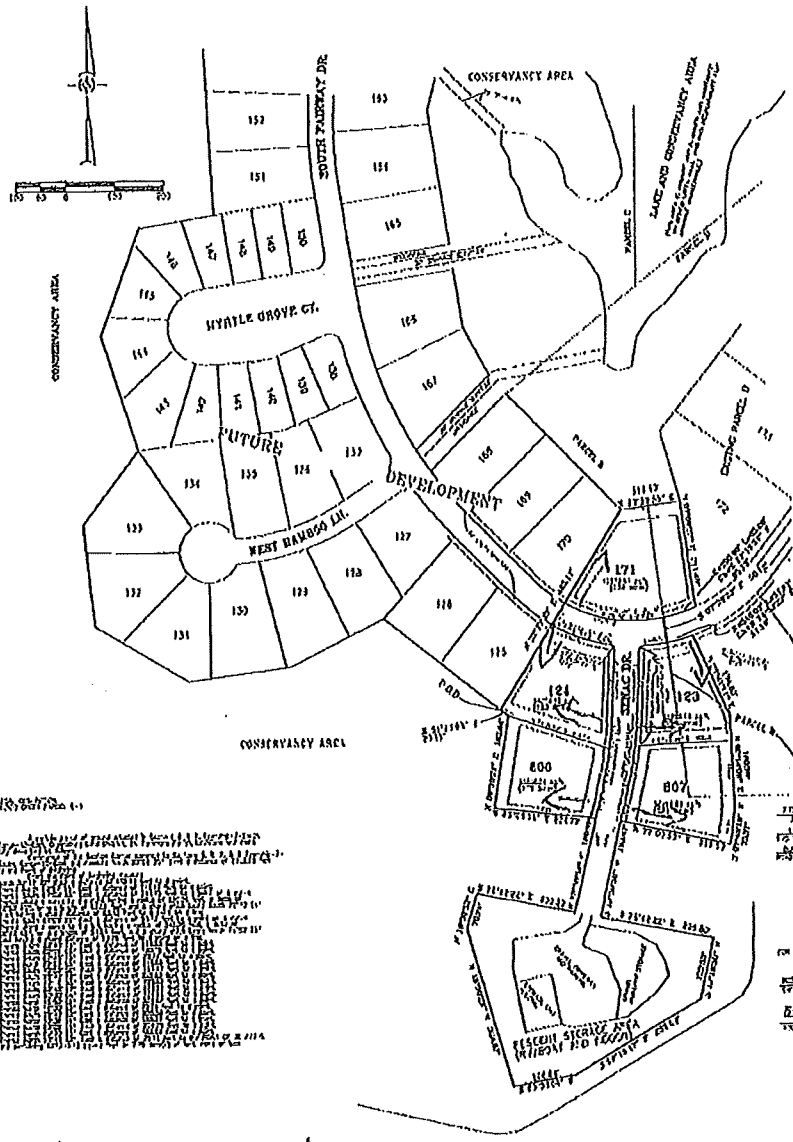

1
2
3
4
5
6
7
8
9
10
11
12
13
14
15
16
17
18
19
20
21
22
23
24
25
26
27
28
29
30
31
32
33
34
35
36
37
38
39
40
41
42
43
44
45
46
47
48
49
50
51
52
53
54
55
56
57
58
59
60
61
62
63
64
65
66
67
68
69
70
71
72
73
74
75
76
77
78
79
80
81
82
83
84
85
86
87
88
89
90
91
92
93
94
95
96
97
98
99
100

FILE NO.	DATE	BY	REVISION
100	10/1/00	JM	1
101	10/1/00	JM	1
102	10/1/00	JM	1
103	10/1/00	JM	1
104	10/1/00	JM	1
105	10/1/00	JM	1
106	10/1/00	JM	1
107	10/1/00	JM	1
108	10/1/00	JM	1
109	10/1/00	JM	1
110	10/1/00	JM	1
111	10/1/00	JM	1
112	10/1/00	JM	1
113	10/1/00	JM	1
114	10/1/00	JM	1
115	10/1/00	JM	1
116	10/1/00	JM	1
117	10/1/00	JM	1
118	10/1/00	JM	1
119	10/1/00	JM	1
120	10/1/00	JM	1
121	10/1/00	JM	1
122	10/1/00	JM	1
123	10/1/00	JM	1
124	10/1/00	JM	1
125	10/1/00	JM	1
126	10/1/00	JM	1
127	10/1/00	JM	1
128	10/1/00	JM	1
129	10/1/00	JM	1
130	10/1/00	JM	1
131	10/1/00	JM	1
132	10/1/00	JM	1
133	10/1/00	JM	1
134	10/1/00	JM	1
135	10/1/00	JM	1
136	10/1/00	JM	1
137	10/1/00	JM	1
138	10/1/00	JM	1
139	10/1/00	JM	1
140	10/1/00	JM	1
141	10/1/00	JM	1
142	10/1/00	JM	1
143	10/1/00	JM	1
144	10/1/00	JM	1
145	10/1/00	JM	1
146	10/1/00	JM	1
147	10/1/00	JM	1
148	10/1/00	JM	1
149	10/1/00	JM	1
150	10/1/00	JM	1
151	10/1/00	JM	1
152	10/1/00	JM	1
153	10/1/00	JM	1
154	10/1/00	JM	1
155	10/1/00	JM	1
156	10/1/00	JM	1
157	10/1/00	JM	1
158	10/1/00	JM	1
159	10/1/00	JM	1
160	10/1/00	JM	1
161	10/1/00	JM	1
162	10/1/00	JM	1
163	10/1/00	JM	1
164	10/1/00	JM	1
165	10/1/00	JM	1
166	10/1/00	JM	1
167	10/1/00	JM	1
168	10/1/00	JM	1
169	10/1/00	JM	1
170	10/1/00	JM	1
171	10/1/00	JM	1
172	10/1/00	JM	1
173	10/1/00	JM	1
174	10/1/00	JM	1
175	10/1/00	JM	1
176	10/1/00	JM	1
177	10/1/00	JM	1
178	10/1/00	JM	1
179	10/1/00	JM	1
180	10/1/00	JM	1
181	10/1/00	JM	1
182	10/1/00	JM	1
183	10/1/00	JM	1
184	10/1/00	JM	1
185	10/1/00	JM	1
186	10/1/00	JM	1
187	10/1/00	JM	1
188	10/1/00	JM	1
189	10/1/00	JM	1
190	10/1/00	JM	1
191	10/1/00	JM	1
192	10/1/00	JM	1
193	10/1/00	JM	1
194	10/1/00	JM	1
195	10/1/00	JM	1
196	10/1/00	JM	1
197	10/1/00	JM	1
198	10/1/00	JM	1
199	10/1/00	JM	1
200	10/1/00	JM	1

1
2
3
4
5
6
7
8
9
10
11
12
13
14
15
16
17
18
19
20
21
22
23
24
25
26
27
28
29
30
31
32
33
34
35
36
37
38
39
40
41
42
43
44
45
46
47
48
49
50
51
52
53
54
55
56
57
58
59
60
61
62
63
64
65
66
67
68
69
70
71
72
73
74
75
76
77
78
79
80
81
82
83
84
85
86
87
88
89
90
91
92
93
94
95
96
97
98
99
100

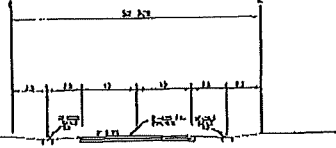

FINAL PLAN
DEDICO CREEK PARCEL C-1
SECTIONS 6 & 7 T-7-S, R-10-E,
GREENSHUO LAND DISTRICT
ST. TAMMANY PARISH, LA
JIMMY J. WELLS & ASSOC., P.A.
PLANNERS & LAND SURVEYORS

EXHIBIT B

